



SOHORAID SR3MS-B31

Well Combination of Hardware RAID and Backup On-Demand

USB Type-C interface, supports Hot-swap Function

SR3MS-B31 follows the excellent industrial design concept of STARDOM, with enhanced Aluminum alloy appearance, new touch button setting and operation interface, and a humanized disk tray module. It is suitable for use in various creative fields.

SR3MS-B31 can install two 2.5" HDD/SSD (RAID 0/1) and one 2.5" HDD/SSD (JBOD). Under RAID 0/1 mode, SR3MS-B31 can instantly protect data and let it has double protection.

Under RAID 1, the disk must be continuously backed up at the same time, which may cause two disks to be damaged at the same time. This will make your important data irretrievable. By using SR3MS-S3, the user can back up the data of the RAID to a separate (JBOD) 2.5-inch hard disk by requesting backup.

Features

1. Multi-function Data Storage, support Mac and PC.
2. Supports RAID and Backup On Demand Functions.
3. Supports USB Type-C and Thunderbolt™ 3 (USB-C) Host.
4. Supports Hot-swap Function.
5. Touch Button Operation Interface, LCM Display and LED Indicator.
6. Low Noise Fan, Fast Heat Dissipation Design.
7. The Sturdy Aluminum Structure Design.

Backup On Demand

RAID 1 is a good way to set data protection, but once your data is damaged by virus attack or 2 hard drives are damaged at the same time, usually users do not have the second data to restore immediately. At this time, the SR3MS-B31 has Complete data or operating system for the first 1/3/7 days, allowing you to operate normally immediately and improve overall work efficiency.

SR3MS-B31 can be directly inserted into the third hard disk to rebuild the hard disk data immediately. When the data reconstruction is completed, your data will immediately form 2 identical full backups.



Supports USB Type-C & Thunderbolt™ 3

The SR3MS-B31 can be connected to any computer or laptop with USB Type-C and Thunderbolt™ 3 (USB-C), delivering up to 6Gbps access performance. Whether for data searching, photo editing, or watching 4K high-definition video, the SR3MS-B31 will bring you unparalleled enjoyment of video and audio quality.



Hot-swappable Design

SR3MS-B31 has built-in 2 2.5" HDD/SSD Tray and 1 2.5" drive tray adapter, which can install 3 2.5" HDD/SSD. Perfect structural design, optimized internal configuration, and enhanced with aluminum alloy shell Protects the internal hard drive. Such high durability is ideal for professional creative fields and mobile mobility applications.

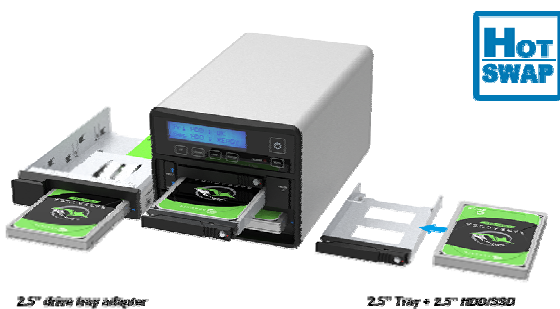

User-friendly Display

SR3MS-B31 has newly added touch button setting and touch power switch operation interface on the front panel. Users only need to turn on the power switch button on the back panel first, and then the SR3MS-B31 can be easily switched on and off through the touch switch, which increases user operation. Convenience. The easy-to-read LCM backlit LCD display provides valuable device data for easy user visibility.



Product Appearance Description

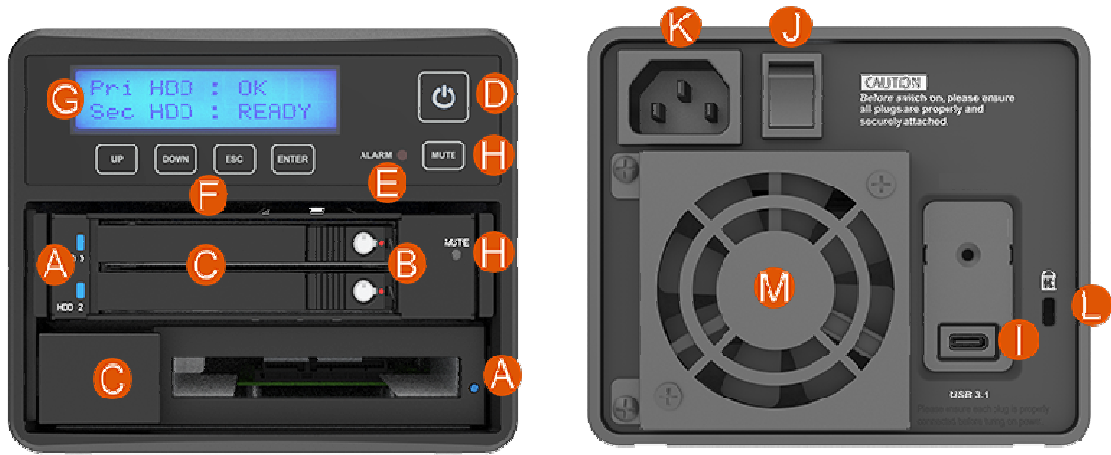

- A. HDD Status Indicator LED
- B. HDD Tray Key Lock
- C. HDD Tray *3
- D. Touch Power
- E. Alarm indicator
- F. Touch Setting Button
- G. LCM Display
- H. Mute Button

- I. USB 3.2 Gen 2 Type-C Port x1
- J. Power Switch
- K. Power Socket
- L. Kensington Security Slot
- M. Cooling Fan

Interfaces	1 x USB 3.2 Gen1 USB-C (5Gbps)
Compatible Drive	2 x 2.5" SATA III (6Gbps) Hard Disk (HDD) or Solid State Disk (SSD) => For RAID 1 x 2.5" SATA III (6Gbps) Hard Disk (HDD) or Solid State Disk (SSD) => For JBOD
Certification	CE / FCC
RAID Mode	RAID 1 / RAID 0 + Backup On Demand
Operation System Support	Windows 7 or above, macOS 10.10 or above, Linux
Cooling Fan	1 x 6cm low noise fan
Electrical and Operating Requirements	*Line voltage: 100-240V, AC *Frequency: 50Hz to 60Hz, single phase *Maximum continuous power: 68W *Operating temperature: 0°to 40°C (32°to 104°F) *Storage temperature: -20°to 47°C (-4°to 116°F) *Relative humidity: 5% to 95%, no condensing
Dimension	Height: 102 mm Width: 122 mm Depth: 205 mm
Product Code	EAN: UPC:
Carton	8 pcs/carton
Package Accessories	1 x SR3MS-B31 1 x USB Type C to Type C cable 1 x Power cable Accessory 1 x Quick Installation Guide